



# Technical Data

## 13 Amp Socket Outlets

### Brief product description:

The subtle design will blend with any décor - suitable for domestic or commercial installations.

### Features:

- Stylish modern profile
- Covers to conceal fixing screws
- Colour coded terminals with backed out captive screws for easy installation
- 2 Earth terminals
- Flush Neon Indicators on 825 & 826

### Product Images



821 / 821DP



822 / 822DP



822DPOB



823



824



825



826

### Technical Specifications

Standard(s)	BS 1363 Part 2
Rating	13 Amp 250V~
Contact Gap	3.0mm minimum
Switch type	Single pole (821, 822, 825, 826 products) Double pole (821DP, 822DP, 822DPOB)
Terminal Capacity - L & N	3 x 2.5mm <sup>2</sup> 3 x 4mm <sup>2</sup> 2 x 6.0mm <sup>2</sup>
RoHS Directive	No
WEEE Directive	No
Mounting Box Depth(Min)	25mm
Fixing Centres	60.3mm (821, 821DP, 823, 825 products) 120.6mm (822, 822DP, 822DPOB, 826 products)
Size	86mm x 86mm x 31mm (821, 821DP, 823, 825 products) 146.5mm x 86mm x 31mm (822, 822DP, 822DPOB, 826 products)

# 13 Amp Socket Outlets

## Line Diagrams



## Packaging Information

Cat No.	Description	Packaging Type			Pack Quantity			Barcode		
		Product	Inner Box	Outer Box	Each	Inner Box	Outer Box	Individual	Inner Box	Outer Box
821	13A 1G SP, SW SKT	Nexus PolyBag	Nexus Inner	Nexus Outer	1	10	100	5050765000550		
821DP	13A 1G DP, SW SKT	Nexus PolyBag	Nexus Inner	Nexus Outer	1	10	100	5050765000581		
822	13A 2G SP, SW SKT	Nexus PolyBag	Nexus Inner	Nexus Outer	1	5	50	5050765000611		
822DP	13A 2G DP, SW SKT	Nexus PolyBag	Nexus Inner	Nexus Outer	1	5	50	5050765000642		
822DPOB	13A 2G DP OB SW SKT	Nexus PolyBag	Nexus Inner	Nexus Outer	1	5	50	5050765018128		
823	13A 1G SKT	Nexus PolyBag	Nexus Inner	Nexus Outer	1	10	100	5050765000673		
824	13A 2G SKT	Nexus PolyBag	Nexus Inner	Nexus Outer	1	5	50	5050765000703		
825	13A 1G SW SKT+Neon	Nexus PolyBag	Nexus Inner	Nexus Outer	1	10	100	5050765000734		
826	13A 2G SW SKT+Neon	Nexus PolyBag	Nexus Inner	Nexus Outer	1	5	50	5050765000765		

## Weights & Dimensions

Cat No.	Description	Dimension (W x L x H) cm			Weight (g)			CMB (m <sup>3</sup> )
		Product	Inner Box	Outer Box	Each	Inner Box	Outer Box	Outer Box
821	13A 1G SP, SW SKT	9.2 x 9.2 x 3.48	15 x 18 x 9.2	31 x 49.5 x 19	106.5	1071	11300	0.029
821DP	13A 1G DP, SW SKT	9.2 x 9.2 x 3.6	15 x 18 x 9.2	31 x 49.5 x 19	111	1171	12300	0.029
822	13A 2G SP, SW SKT	9.2 x 15.2 x 3.41	14.5 x 18 x 9.2	30 x 49.5 x 19	170.5	922	9700	0.028
822DP	13A 2G DP, SW SKT	9.2 x 15.2 x 3.41	14.5 x 18 x 9.2	30 x 49.5 x 16	172.5	922	9700	0.023
822DPOB	13A 2G DP OB SW SKT	9.2 x 15.2 x 3.41	14.5 x 18 x 9.2	30 x 49.5 x 16	172.5	922	9700	0.023
823	13A 1G SKT	9.2 x 9.2 x 3.48	15 x 18 x 9.2	31 x 49.5 x 19	145.5	974	10300	0.029
824	13A 2G SKT	9.2 x 15.2 x 3.48	12.5 x 18 x 9.2	30 x 49.5 x 16	168	852	9000	0.023
825	13A 1G SW SKT+Neon	9.2 x 9.2 x 3.48	15 x 18 x 9.2	31 x 49.5 x 19	145.5	1104	11600	0.029
826	13A 2G SW SKT+Neon	9.2 x 15.2 x 3.41	14.5 x 15 x 9.2	30 x 49.5 x 16	168.5	937	9850	0.028

# 13 Amp Socket Outlets

## Installation Information

### Safety Warning

Before use please read carefully and use in accordance with these safety wiring instructions.

Before commencing any electrical work ensure the supply is **switched off at the mains**. Either by switching off the consumer unit or by removing the appropriate fuse.

Wiring should be in accordance with the latest edition of the IEE regulations (BS 7671).

### Wire Identification – Twin & Earth Cable

EARTH = Green/Yellow Slewing

NEUTRAL = Black (pre Apr 04) / Blue (after Apr 04)

LIVE = Red (pre Apr 04) / Brown (after Apr 04)



**Technical Helpline: 0845 194 7584**  
If in doubt consult a competent electrician.

The ends of the individual conductors should have the insulation removed by approx. 12mm. Any bare earth conductors should be sleeved to within 12mm of the ends. (These details are for general information only and conductor lengths may need to be trimmed in certain installations).

### General Installation Instructions

- 1) If using the new product to replace an old one, note the cable connections and wire up new product in the same way as the old one, with Earthing as stated in these instructions.
- 2) Ensure the mounting box (metal or patress) for either flush or surface mounting is the appropriate size for the product.
- 3) Route the cable through the most suitable entry point of the mounting box. If a metal box is used, a protective cable grommet should be used.
- 4) Cables should be prepared so a sufficient conductor length reaches the terminals. Strip the ends of the individual conductors so that an adequate length enters the terminals.
- 5) Carefully arrange the wiring to lie along the edges of the product or box, keeping the central area clear.
- 6) To assist with the correct installation please consult the appropriate wiring diagram on this leaflet.
- 7) When connecting the new accessory ensure that only the bare end of the wire enters the terminal, and no bare wires are visible.

Always tighten the terminal screws securely, but do not overtighten.

An earth connection should always be made between the mounting box earth terminal, and the accessory earth terminal, where fitted. If this earth wire is bare, it is essential that it is sheathed with a length of green/yellow sleeving.

8) Carefully position the accessory into the wall box, ensuring that no wires are trapped between the plate and the wall. Do not overtighten the screws. (Fit screw covers + clip-on)

9) Once work has been completed correctly, replace the fuse for the circuit, switch the power back on, and test.

The product is now ready for use.

\* Note - If your installation uses a four lug metal mounting box, remove the top and bottom lugs or bend fully back.

### 1 Gang 13 Amp Switched Socket

This socket is fitted with with two linked terminals to provide a dual earth facility. This is for use in "clean earth" installations where additional earth capacity is required to comply with Regulation 607 of BS7671 IEE Wiring Regulations.

Connect the cables as shown in the diagram.

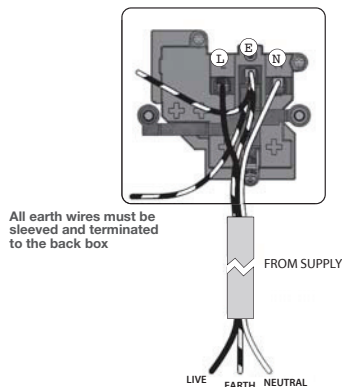

### 1 Gang 13 Amp Unswitched Socket

Connect the cables as shown in the diagram.

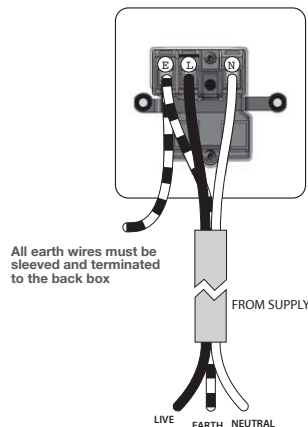

### 2 Gang 13 Amp Switched Socket

This socket is fitted with with two linked terminals to provide a dual earth facility.

This is for use in "clean earth" installations where additional earth capacity is required to comply with Regulation 607 of BS7671 IEE Wiring Regulations.

Connect the cables as shown in the diagram.

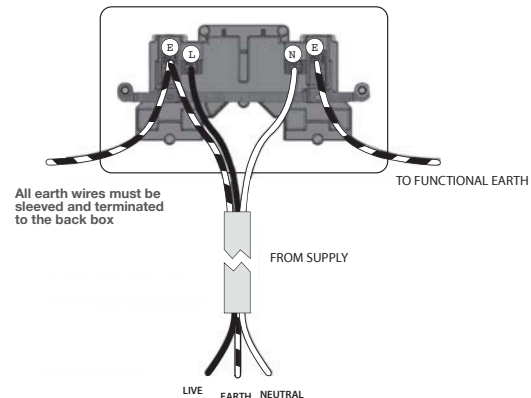

### 2 Gang 13 Amp Unswitched Socket

This socket is fitted with with two linked terminals to provide a dual earth facility.

This is for use in "clean earth" installations where additional earth capacity is required to comply with Regulation 607 of BS7671 IEE Wiring Regulations.

Connect the cables as shown in the diagram.

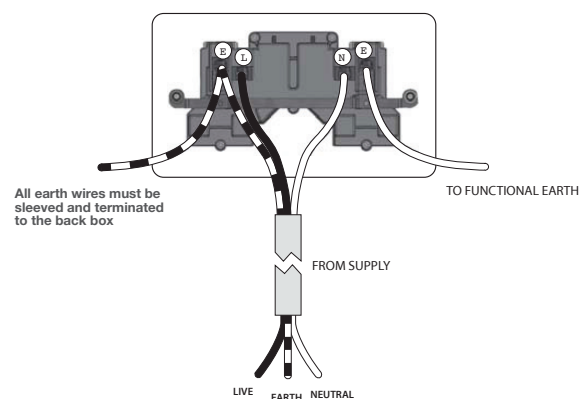

### 2 Gang 13 Amp Switched Socket – Outboard Rockers

This socket is fitted with with two linked terminals to provide a dual earth facility. This is for use in "clean earth" installations where additional earth capacity is required to comply with Regulation 607 of BS7671 IEE Wiring Regulations.

Connect the cables as shown in the diagram.

